

# How to capture CAN adapter log from FMX1YX

[Main Page](#) > [Frequently Asked Questions - FAQ](#) > **How to capture CAN adapter log from FMX1YX**



## Contents

- [1 Solution applies for these devices](#)
  - [1.1 Using Teltonika Configurator](#)
  - [1.2 Using FOTA WEB](#)

## Solution applies for these devices

[FMB110](#) [FMB120](#) [FMB122](#) [FMB125](#) [FMB130](#) [FMB140](#) [FMB150](#) [FMB225](#) [FMB230](#) [FMB240](#)  
[FMC125](#) [FMC130](#) [FMC150](#) [FMC225](#) [FMC230](#)  
[FMM125](#) [FMM130](#) [FMM150](#) [FMM230](#)

Here are steps how to capture LV-CAN200, ALL-CAN300, CAN-CONTROL log from FMB1YX series devices.

This functionality is available after **03.08.00** firmware version.

1. Make sure that the CAN adapter is [connected properly](#) to the vehicle and to the FMB1YX series device.
2. **Start vehicle engine.**
3. Send following **SMS commands** to FMX1YX device:
  - If you have set SMS login and password: `login pass log2sdfilterset 0;2;3;4;1`
  - If SMS login and password are not set leave two spaces before command:  
 `log2sdfilterset 0;2;3;4;1`

If command `log2sdfilterset` was sent correctly you should receive SMS Response: `Enabled Trace Filters:5` then you can restart the device
4. If FW version is **03.27.10** or higher `cpureset` command is not necessary to enable the filters. On lower versions `cpureset` is mandatory.
  - If you have set SMS login and password: `login pass cpureset`
  - If SMS login and password are not set leave two spaces before command:  `cpureset`
5. After the SMS response message CAN adapter log capturing has been started.
6. Wait at least **5 minutes** to get enough CAN bus data and **turn off** vehicle engine.
7. **Download** captured log (dump) files.

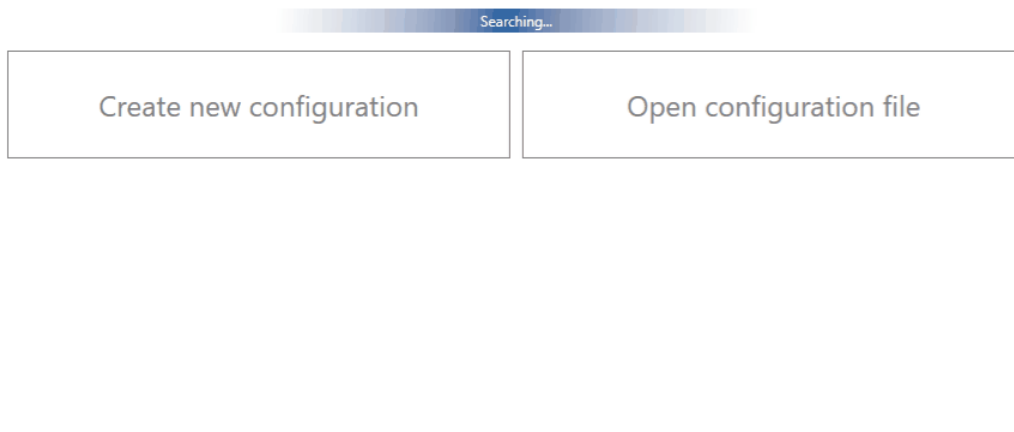

## Using Teltonika Configurator



Please check [Status info→Maintenance→Log/Dump](#) and download dump  
YYYY\_MM\_DD\_HH\_MM\_SS\_FMB1YX\_IMEI\_Dump.zip.

## Using FOTA WEB



Enter FOTA WEB → Press on **Devices** tab → Select your device and press  → **Task type** → **Receive internal log (10)** (10 files. Each log size up to 1 MB) → **Begin Download: From Oldest** → **Files to Download 10** → .

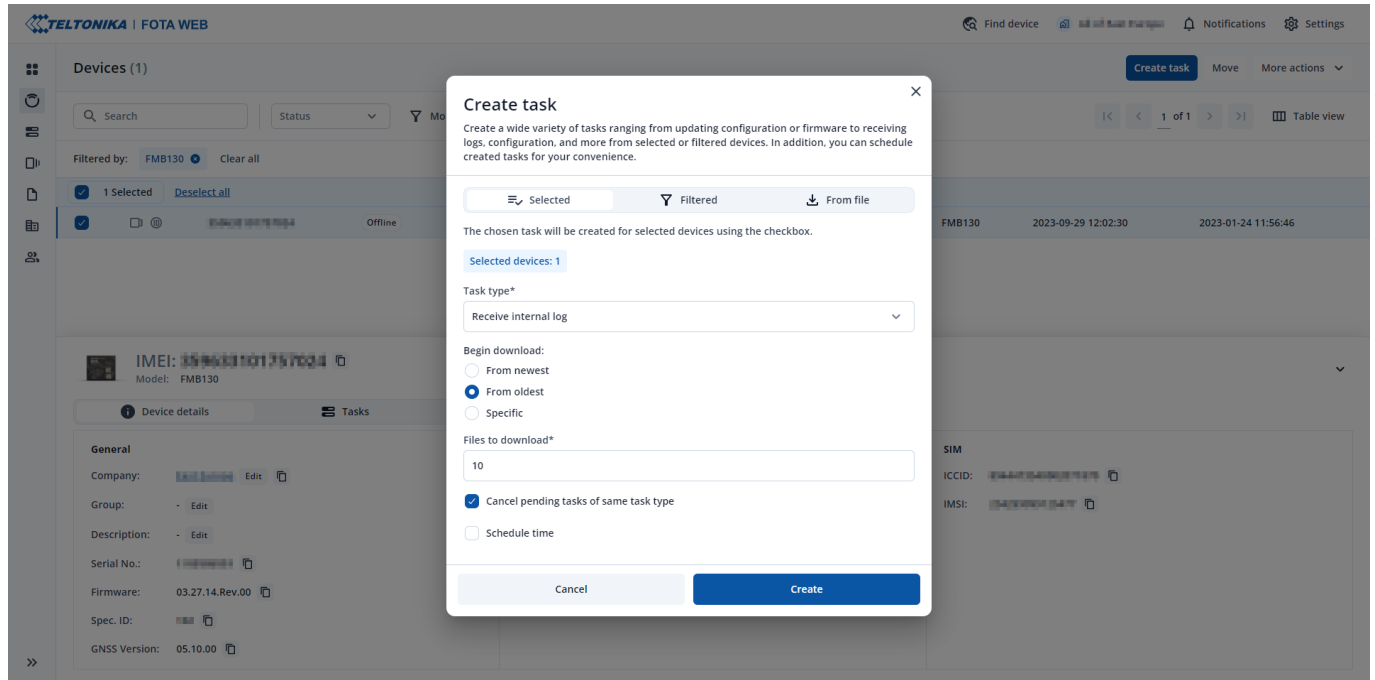

To start download process at once send following SMS command:

- If you have set SMS login and password: `login pass web_connect`
- If SMS login and password are not set leave two spaces before command:  
`web_connect`

If command was sent correctly you should receive SMS Response: `web_connect`

resp:OK

To find downloaded log press on **Tasks** tab→Find your device by IMEI and Task type **Received internal log**→Download IMEI\_logs\_TIMESTAMP.zip as showed below:



2. After you have downloaded log files send following **SMS command** to FMX1YX device:

- If you have set SMS login and password: login pass log2sdfilterset 0
- If SMS login and password are not set leave two spaces before command:  
aa log2sdfilterset 0

If command was sent correctly you should receive SMS Response:Enabled Trace Filters:1

3. These log (dump) files can be read only with **special software**. Provide these files to your **Teltonika Telematics Sales manager** or **Teltonika Telematics Support team** for further investigation.